

PLANTA UNIT. DA RUA
ESC: 1:75

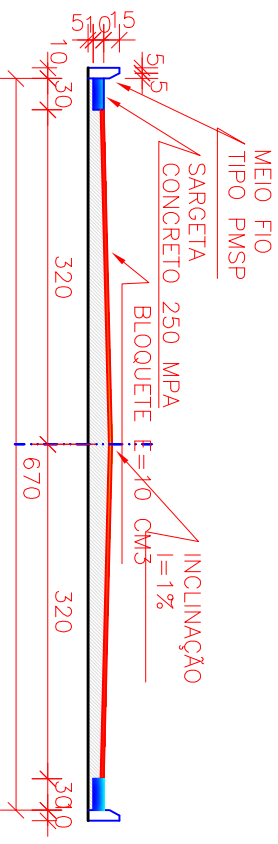

PERFIL DA RUA
ESC: 1:75

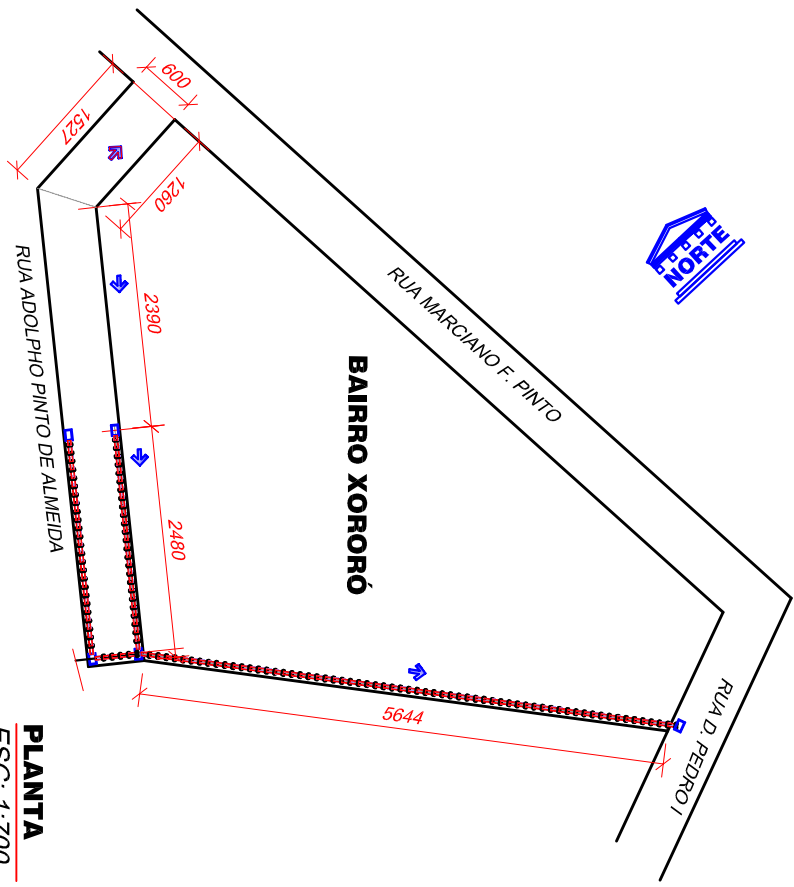

PLANTA
ESC: 1:700

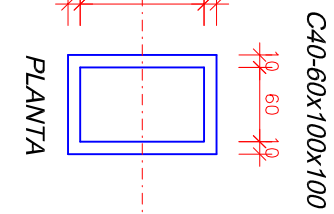
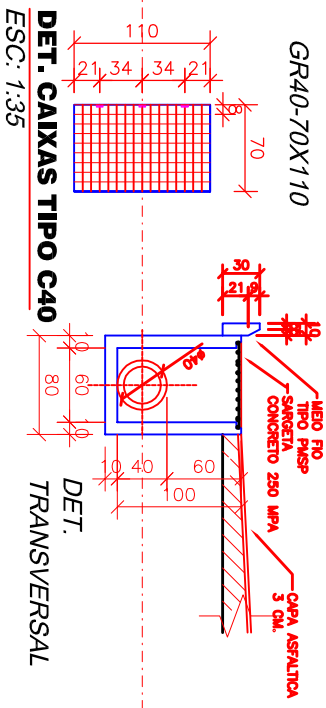

DET. TRANSVERSAL

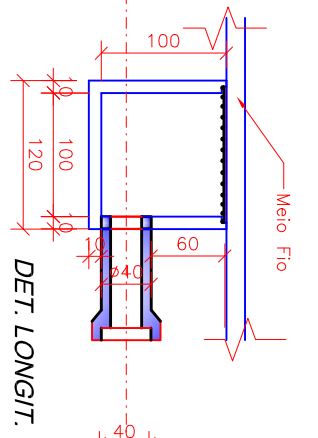

DET. LONGIT.

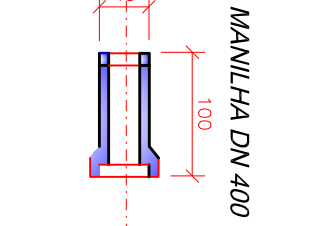

MANILHA DN 400

GR40-70X110

C40-60x100x100

PREFEITURA M. CAMPANHA
Depto Projetos & Obras
Rua Dr. Brandão no. 59 - Tel: 3261-1427 - Campanha MG

DESENHISTA
ROBERTO

End. da Obra: RUA ADOLPHO PINTO DE ALMEIDA - CPAMG
Proprietário: PREF. M. CAMPANHA
Conteúdo: PROJETO CALÇAMENTO

CNPJ- 18.712.174/0001-42
A. TERR. 0 m²
A. CONST. 0 m²
Eng.

DATA
07/10/2009

FOLHA
01.03